

CUBRO



Koval walking trolleys range

Height adjustment at the push of a button



Koval electric walking trolley

Electric walking trolley

Designed for rehabilitation after injuries and operations, the Koval electric walking trolley is easy to adjust, enabling users to have safe and independent movement and giving them safe support during standing up and walking.

Rather than a lengthy and difficult process to adjust the height of standard gutter frames, the height of the walking trolley can be effortlessly adjusted in seconds using the electric handset provided.

The trolley can be used to assist in early-mobilisation and for rehabilitation after injuries and operations.

Product code: 66932



Height adjustment with handset



Features

- Used by patients with reduced mobility
- Designed especially to help patients to stand up
- Padded armrests for increased comfort
- Each castor is equipped with brakes for safety
- Adjustable gripped handles
- Electric height adjustment using handset

Specifications

Overall dimensions	L	750mm
	W	720mm
Safe working load		170kg
Braking type		Individual braking
Adjustable height	Min.	880mm
	Max.	1280mm
Product weight		22kg



Using the Koval electric walking trolley

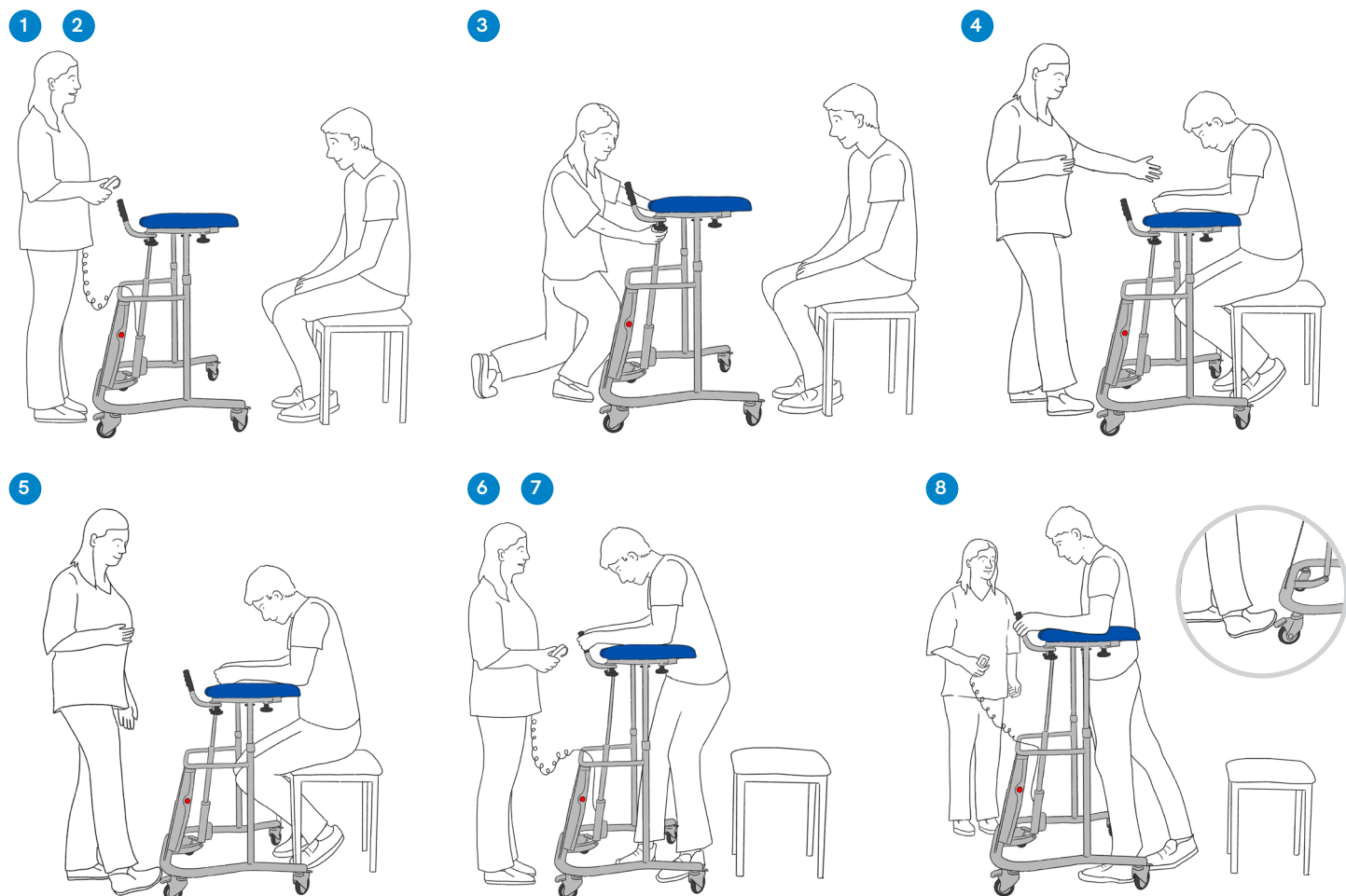

- 1 Always inform the patient of what you are about to do.
- 2 Set the walking trolley height to the lowest position by pressing the down arrow on the handset and approach the patient.
- 3 Adjust the width of the armrests to increase patient comfort.
- 4 Position the walking trolley to allow the patient to lean on the armrests.
- 5 Apply the brakes on all castors.
- 6 Help or encourage the patient to grab both handles and use them to stand up.
- 7 Assist/help the patient to stand up by pressing the up arrow on the handset.
- 8 Release the brakes and allow the patient to walk.

Koval maxi walking trolley

Bariatric walking trolley

Designed for bariatric patients, the Koval maxi walking trolley allows users to have safe and independent movement. Rather than a lengthy and difficult process to adjust the height of standard gutter frames, the height of the Koval maxi walking trolley can be adjusted effortlessly, to help patients get up from a chair or bed and for rehabilitation after injuries and operations.

Product code: **66933**



Features

- Designed for bariatric patients
- Supports patients in standing and walking
- Padded armrests for comfort
- Each castor is equipped with brakes for safety
- Adjustable gripped handles
- Fast and efficient electric height adjustment using the handset provided

Specifications

Overall dimensions	L	750mm
	W	870mm
Safe working load		300kg
Braking type		Individual braking
Castor size		100mm
Adjustable height	Min.	900mm
	Max.	1300mm
Product weight		26kg



Using the Koval maxi walking trolley

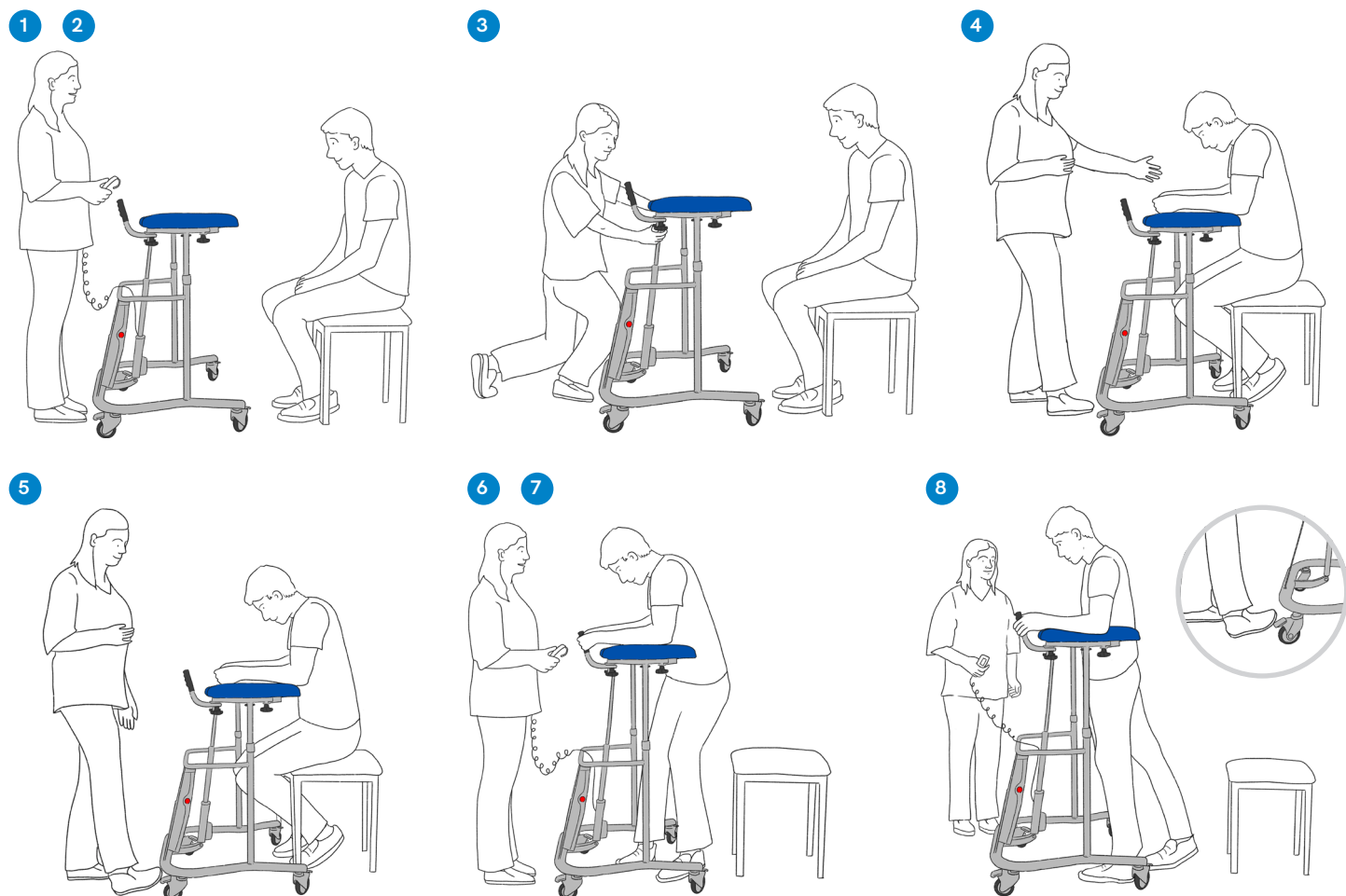

- 1 Always inform the patient of what you are about to do.
- 2 Set the walking trolley height to the lowest position by pressing the down arrow on the handset and approach the patient.
- 3 Adjust the width of the armrests to increase patient comfort.
- 4 Position the walking trolley to allow the patient to lean on the armrests.
- 5 Apply the brakes on all castors.
- 6 Help or encourage the patient to grab both handles and use them to stand up.
- 7 Assist/help the patient to stand up by pressing the up arrow on the handset.
- 8 Release the brakes and allow the patient to walk.

Koval walking trolley

Gas spring walking trolley

Designed for users with reduced mobility, the Koval gas spring walking trolley allows users to have independent movement by giving them safe support when standing and walking. With fast and simple height adjustment in seconds, the trolley can be used for support when getting up from a chair or bed and for rehabilitation after injuries and operations.

Product code: **66930**



Height adjustment with gas springs



Features

- Designed for patients with reduced mobility
- Supports patients in standing and walking
- Padded armrests for comfort
- Individually braking castors for safety
- Adjustable gripped handles
- Height adjustment in seconds with gas springs

Specifications

Overall dimensions	L 750mm
	W 720mm
Safe working load	170kg
Braking type	Individual braking
Castor size	100mm
Adjustable height	Min. 1040mm
	Max. 1340mm
Product weight	17.2kg



Using the Koval gas spring walking trolley

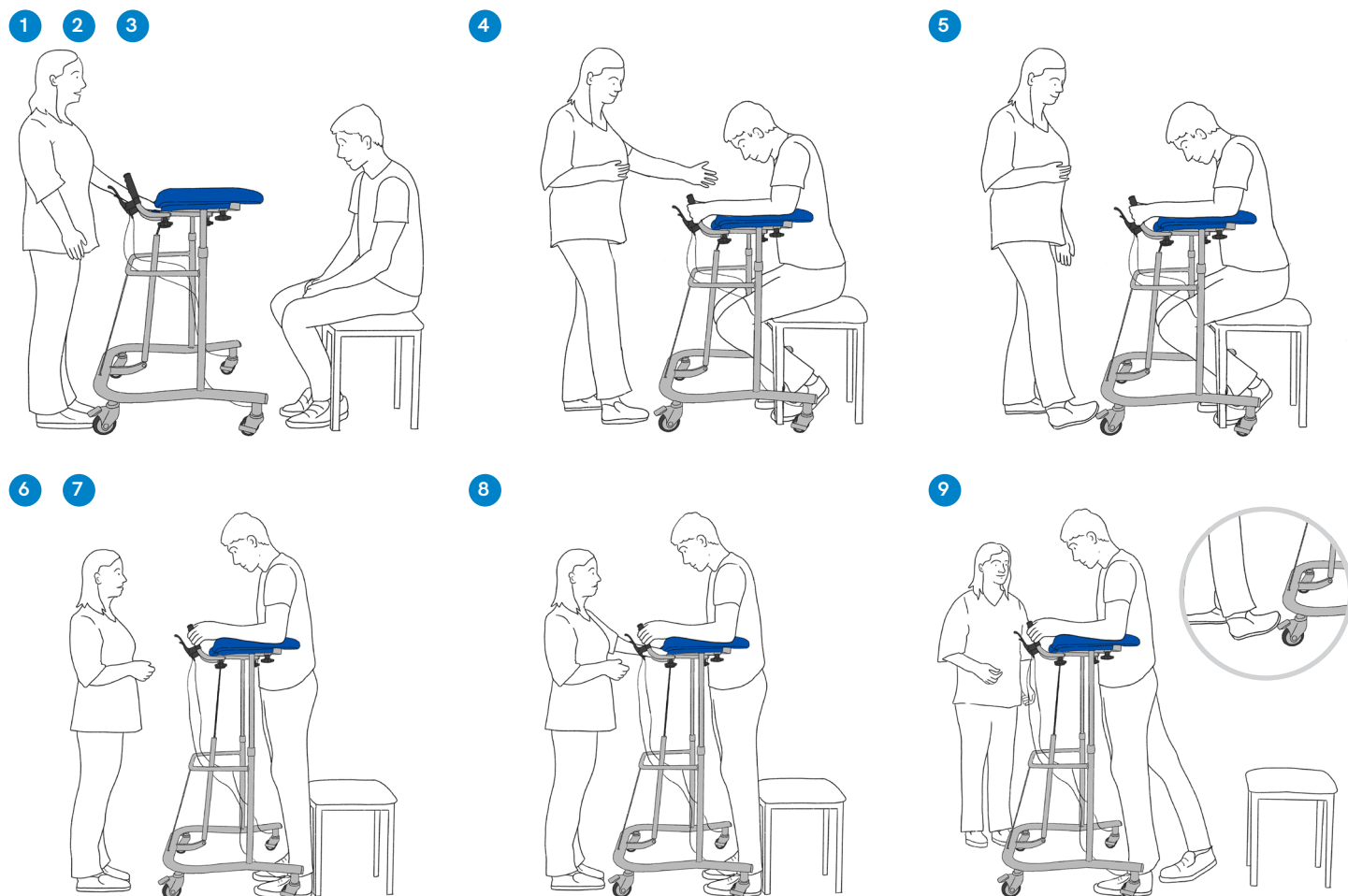

- 1 Always inform the patient of what you are about to do.
- 2 Set the walking trolley height to the lowest position and approach the patient.
- 3 Adjust the width of the armrests to increase patient comfort.
- 4 Position the walking trolley to allow the patient to lean on the armrests.
- 5 Apply the brakes on all castors.
- 6 Help or encourage the patient to grab both handles and use them to stand up.
- 7 Assist/help the patient to stand up, if needed.
- 8 Set the desired height by pressing the gas spring release lever.
- 9 Release the castor brakes to allow the patient to walk.



To find out more please get in touch on **0800 656 527**,
email sales@cubro.co.nz or visit cubro.co.nz