



## Contour Portare Servicing



## Contour Portare Servicing

Thank you for placing your confidence in our Stretchers. They have been engineered from quality materials and hand-made with care to fulfil the requirements of the healthcare industry. Your stretcher will give years of trouble-free service if used and cared for in accordance with our directions.

As an Australian manufacturer with the longest warranty, we're committed to delivering the best value in the healthcare industry. If you have a maintenance issue with any of our products, we can help to get you back up and running again very quickly.

All of our parts are usually in stock ready for a 24 hour dispatch. Identify any [Contour Portare Stretcher](#) parts that you may need for an emergency repair or future maintenance, and contact us today for a fast, fairly priced response.

To facilitate quick and accurate identification, please supply the **SERIAL NUMBER** found on the **MODSEL** manufacturers label of the product.

Routine inspection of castors and other frame components can usually prevent common problems. After each (12) twelve months of use, the trolley must be checked in accordance with our recommended Service Checklist.

[An approved \*\*MODSEL Service Checklist\*\* can be downloaded online from this link](#)

**TO ENSURE WARRANTY, PERIODIC MAINTENANCE RECORDS MUST BE RETAINED.**

### Disposal

- Contact Modsel or your institution expert for advice on disposal of this device.
- DO NOT repurpose this device. Modsel as the legal manufacturer of this medical device can advise if it can be reconditioned.

# How To Service The Dropsides

Refer to the separate [Dropside Servicing](#) guide.

## How To Remove The Plastic Base Cover

1. Fully raise the height of the stretcher top.
2. Lift the plastic base cover up and then twist/roll it sideways.
3. Slide the entire cover out of the base frame through the lifting legs.
4. To replace, follow reverse procedure.

## How To Replace The Lifters

1. Firstly ensure the base cover is free and then lay the stretcher on its side on the ground. This can be done by the following steps;
2. Stand facing the side of the stretcher – the side to stand on must be the side that you want to have lain down on the ground.
3. Pull stretcher towards you until all castors are at 90° to the length of the stretcher (facing away from you) and apply the brakes.
4. With the help of another person, firmly hold end rails at either end of the stretcher and carefully tilt it over until top makes contact with the ground.
5. Remove the retaining pins from the ends of the lifter.
6. Replace with new lifter ensuring that the new one is positioned correctly.
7. Reassemble in the reverse order to the steps above.

# How To Adjust The Brake/Steer System

Wear from continuous use may cause the trolley brake or steer action to not lock in properly over time. This may need to be corrected by adjusting the length of the Brake Linkage Rod.

1. Lock the right hand brake/steer pedal (from the foot end of the trolley) into the brake position. Check that the head end pedal on the same side is locking fully into the brake position at the same time. If not, the Brake Linkage Rod may need to be shortened or lengthened accordingly, to equalise the operation.
2. To adjust the Brake Linkage Rod, lift or remove the plastic base cover as per instructions above.
3. Loosen the rod end lock nut.
4. Remove the rod end retaining bolt and nut and then wind the rod end a half turn in (clockwise) to shorten or out to lengthen the Brake Linkage Rod.
5. Assemble the rod end retaining bolt loosely and test the brake/steer action. Continue to adjust the rod end until the system operates correctly.
6. Re-assemble, locking all bolts and nuts tight.

# How To Replace a Castor

1. Check the replacement castor is the correct type (ie. brake or brake/steer, Catis or Tente brand).
2. Remove or lift up the plastic base cover as per the instructions above.
3. Set the brake pedal the neutral position. Loosen the pedal lock screws at castor to be removed. Using a suitable marker pen, mark the position of the hex lug on the hex rod. Loosen the lock screw on the hex lug to allow the hex rod to slide through. Use a pin punch on the end of the hex rod, to drive clear of the castor.
4. Release the lock tab and remove the castor retaining bolts. Remove old castor. Remove any plastic bolt-hole plugs if in the castor spigot and insert the replacement castor. **DO NOT ROTATE THE CASTOR SPIGGOT, AS THIS MAY ALTER THE CASTOR SETTINGS.**
5. Align the hex rod with the hole in the castor spigot. If the hex rod will not slide through the spigot, remove and rotate entire castor 180° and re-fit. Tap the hex lug back into the original position using a soft hammer and tighten lock screw using medium strength thread locker. Replace the castor retaining bolts together with the existing or new lock tab. Tighten the castor lock screws. Bend bolt locking tabs into position against bolt heads.
6. Replace brake pedal ensuring adequate clearance both sides of the base for the cover.

# Spare Part Identification

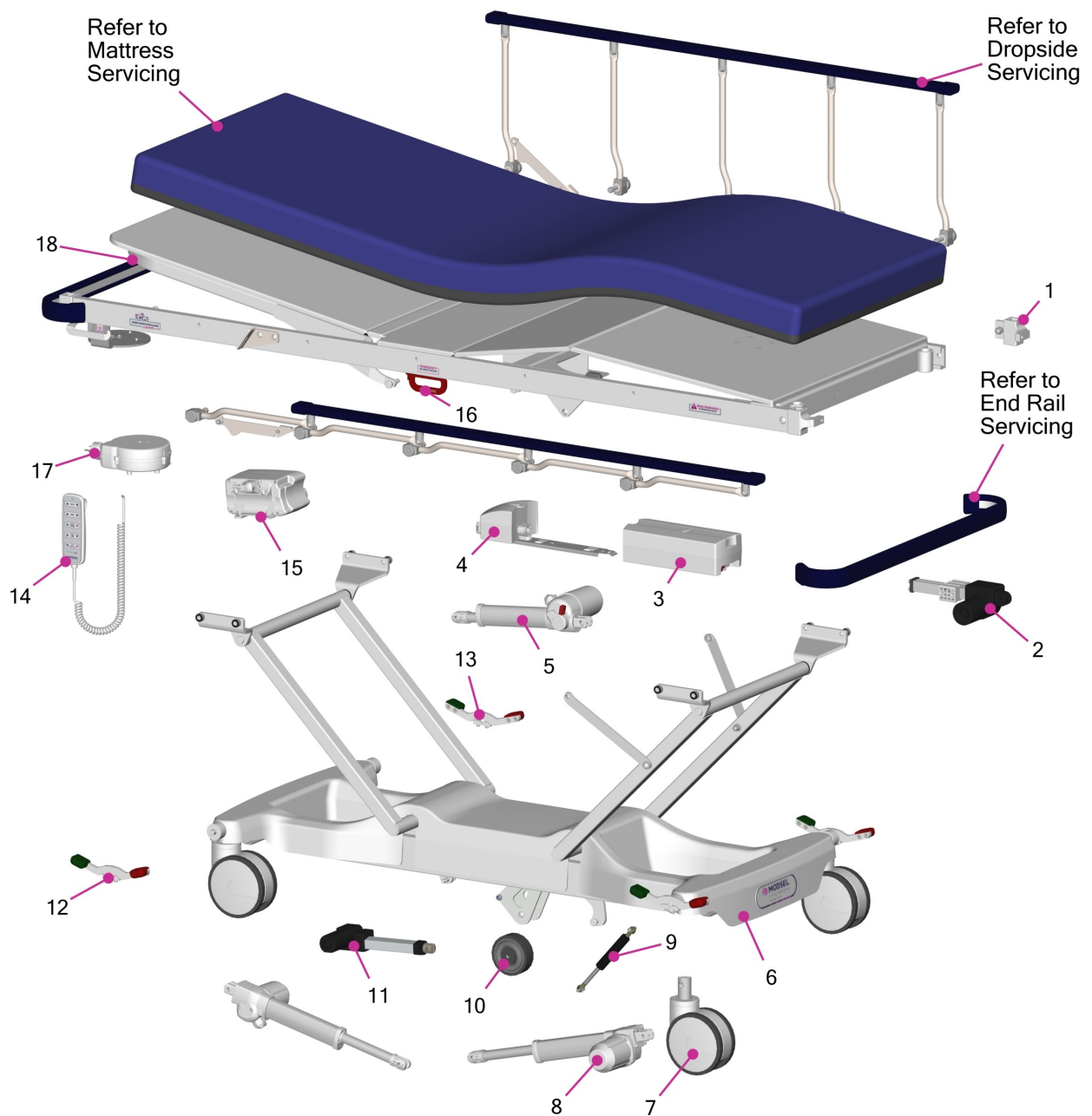

**Overall Size:** 2135 x 815mm overall size (965mm wide top option)

# Spare Part Identification Table

Pricing in AUD, excludes GST and freight

Item	Code	Description	Price
1	MPT-C0001	Corner Casting	\$39
2	0763	Knee Bend Actuator	\$120
3	0775	Dewert Battery	\$270
4	0772	Battery Interface	\$110
5	0787	Backrest Actuator	\$260
6	P0150	Base Cover	\$580
7	P0070	Twin Wheel Castor	\$180
8	P0135	Portare Hi-Lo Actuator	\$240
9	4035	5th Wheel Strut-600N	\$64
10	7024	Wheel-Ezi Trak	\$18
11	P0131	Ezi Track Actuator	\$120
12	P0080	Steer/Brake Pedal Assembly-LH	\$75
13	P0075	Steer/Brake Pedal Assembly-RH	\$75
14	0785	Handset	\$150
15	0771	Control Box	\$440
16	P0200	CPR Release Lever Assembly - Standard	\$120
16.1	P0201	CPR Release Lever Assembly - Wide	\$120
17	0768	Cable Retractor	\$156
18	P0310	Portare Backrest Frame-Standard	\$310
18.1	P0315	Portare Backrest Frame-Wide	\$330



